

# SLIMLINE DROP-IN SEALED WELL ELECTRIC UNIT



**DISLSW-2-120 Shown**

Item #: \_\_\_\_\_ Qty #: \_\_\_\_\_

Model #: \_\_\_\_\_

Project #: \_\_\_\_\_

## FEATURES:

Fiberglass insulation between each compartment  
12" x 20" die stamped openings  
Full stainless steel construction inside and out.  
Remote control panel  
Units are supplied with drains for wet or dry application  
Includes 1" I.P.S. Drain(s) with Gate Valve

## MATERIAL:

**TOP:** 18 gauge #304 stainless steel with die stamped pan openings and self rimmed. (12" x 20" opening)  
**BODY:** 20 gauge galvanized



## ELECTRICAL:

120V units yield 1100 Watts  
208V/240V dual voltage units yield 825 Watts at 208V and 1100 Watts at 240V  
Infinite control knobs  
Indicator lights

**Unit to be hard wired in the field. Optional cord sets available, please consult the factory for more information**

| Model #             | O.A. Length | O.A. Width | # of Wells | Cut-Out Size      | Volts   | Amps        | Watts     | Approx. Wt. | Cu. Ft. |
|---------------------|-------------|------------|------------|-------------------|---------|-------------|-----------|-------------|---------|
| <b>DISLSW-2-120</b> | 47-9/16"    | 16-7/16"   | 2          | 15-1/8" x 45-7/8" | 120     | 18.33       | 2200      | 125 lbs.    | 12.8    |
| <b>DISLSW-3-120</b> | 70-3/8"     | 16-7/16"   | 3          | 15-1/8" x 68-3/4" | 120     | 27.51       | 3300      | 150 lbs.    | 18.6    |
| <b>DISLSW-2-240</b> | 47-9/16"    | 16-7/16"   | 2          | 15-1/8" x 45-7/8" | 208/240 | 3.94/9.16   | 1600/2200 | 125 lbs.    | 12.8    |
| <b>DISLSW-3-240</b> | 70-3/8"     | 16-7/16"   | 3          | 15-1/8" x 68-3/4" | 208/240 | 11.90/13.34 | 2475/3300 | 150 lbs.    | 18.6    |
| <b>DISLSW-4-240</b> | 93-3/16"    | 16-7/16"   | 4          | 15-1/8" x 91-1/2" | 208/240 | 15.88/18.32 | 3300/4400 | 174 lbs.    | 24.5    |

**NOTE: Units are not designed to cook or heat frozen or refrigerated foods. Food placed in tables should already be hot, and the table will maintain the proper temperatures**

## Optional Accessories:

*Visit our website for additional Accessories*



**Manifold Drains (Per Well)**  
Add The Suffix **-M** To The Model Number.

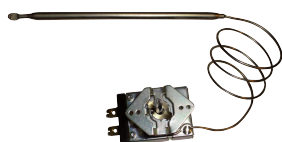



**Thermostatic Controls**  
Add The Suffix **-T** To The Model Number.



**Adapter Bars**  
**SU-45A** 12" x 1" Adapter Bar.  
**3-Phase Upgrade**  
**SU-72** Upgrade to 240 volt units to 3 Phase Wiring.

## Cord with NEMA Plugs

|                 |   |   |
|-----------------|---|---|
| <b>SU-P-230</b> | 6' Cord with <b>NEMA 5-20P</b> plug for 2 or 3 well, 120v Units |  |
| <b>SU-P-232</b> | 6' Cord with <b>NEMA 6-20P</b> plug for 2 or 3 well, 240v Units |  |
| <b>SU-P-233</b> | 6' Cord with <b>NEMA L6-30P</b> plug, for 4 well, 240v Unit     |  |

# DIMENSIONS and SPECIFICATIONS

TOL ± .125"

ALL DIMENSIONS ARE TYPICAL

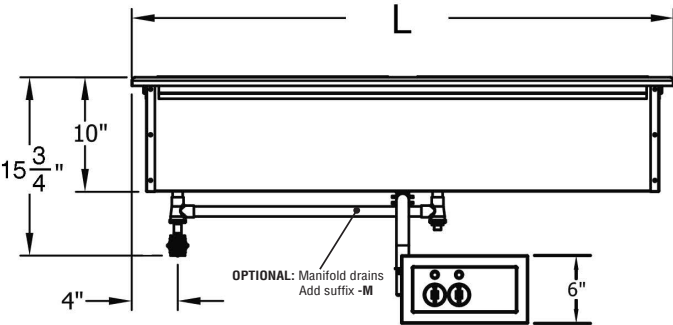
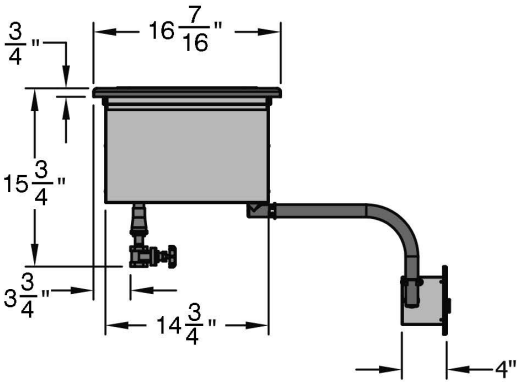
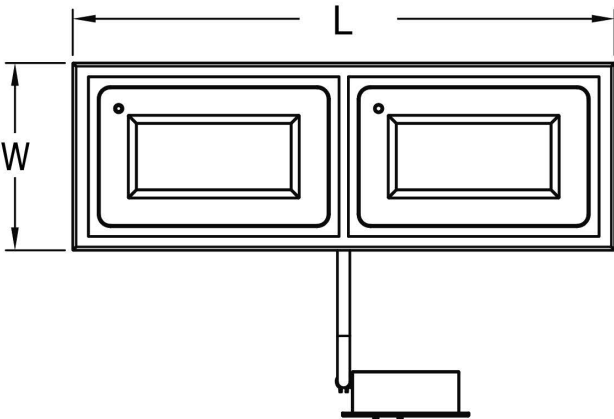

| Model #  | Cut-Out Size Length (A) | Cut-Out Size Height (B) | Front Panel Length (C) |
|----------|-------------------------|-------------------------|------------------------|
| DISLSW-2 | 9 -1/2"                 | 4 -5/16"                | 11 -1/8"               |
| DISLSW-3 | 15 -3/8"                | 4 -5/16"                | 17"                    |
| DISLSW-4 | 15 -3/8"                | 4 -5/16"                | 17"                    |

Unit to be hard wired in the field. See Accessories for optional Cords.  
Please consult the factory for more information.

